

LOWER LEVEL LEASING DATA		
SUITE	SPACE / TENANT	AREA
872	A-1	3,300 SF
	A-3	1,216 SF
888	A-4	3,634 SF
	---	-----
886	A-6	2,025 SF
884	A-7	1,350 SF
880	A-8	2,104 SF
882	A-10	13,420 SF
888	A-12	900 SF
886	A-13	900 SF
884	A-14	740 SF
882	A-15	532 SF
802	B-1	2,172 SF
804	B-2	1,200 SF
806	B-3	1,200 SF
808	B-4	1,008 SF
810	B-5	1,200 SF
816	B-6	1,209 SF
812	---	-----
818	C-100	555 SF
842	C-101	555 SF
828	C-105	1,240 SF
830	C-106	1,532 SF
834	C-109	3,745 SF
824	C-112	4,110 SF
	C-212	2,100 SF
842	D-100	6,820 SF
	---	-----
	---	-----
	---	-----
	---	-----
874	STAGE	
878	E-1	235 SF
876	G-1	353 SF

UPPER LEVEL LEASING DATA		
SUITE	SPACE / TENANT	AREA
924	C-200	680 SF
922	C-201	700 SF
920	C-202	560 SF
918	C-203	560 SF
916	C-204	560 SF
908	C-205	560 SF
910	C-206	560 SF
912	C-207	560 SF
914	C-208	560 SF
906	D-200	420 SF
904	D-201	420 SF
898	D-202	560 SF
896	D-203	560 SF
894	D-204	560 SF
892	D-205	560 SF
882	D-206	560 SF
884	D-207	560 SF
886	D-208	560 SF
888	D-209	420 SF
890	D-210	420 SF

**SHORELINE HOLDINGS, LLC**  
 700 MONTGOMERY HIGHWAY - SUITE 186  
 Birmingham, Alabama 35216  
 PHONE: 205.985.1000

# SHORELINE VILLAGE

CITY OF DESTIN, FLORIDA

## SITE DATA

SHOPS A	31,121 SF
SHOPS B	7,980 SF
SHOPS C (LOWER LEVEL)	11,747 SF
SHOPS D (LOWER LEVEL)	6,820 SF
SHOP E	235 SF
SHOP G	353 SF
TOTAL GLA (LOWER LEVEL)	57,265 SF
SHOPS C (UPPER LEVEL)	7,400 SF
SHOPS D (UPPER LEVEL)	5,600 SF
TOTAL GLA (UPPER LEVEL)	13,000 SF
TOTAL GLA (UPPER AND LOWER)	70,265 SF
PROPERTY ACREAGE - ±10.0 ACRES	
PROPERTY ZONED - COMMERCIAL	

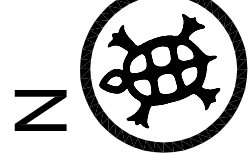

GRAPHIC SCALE



# SHORELINE VILLAGE

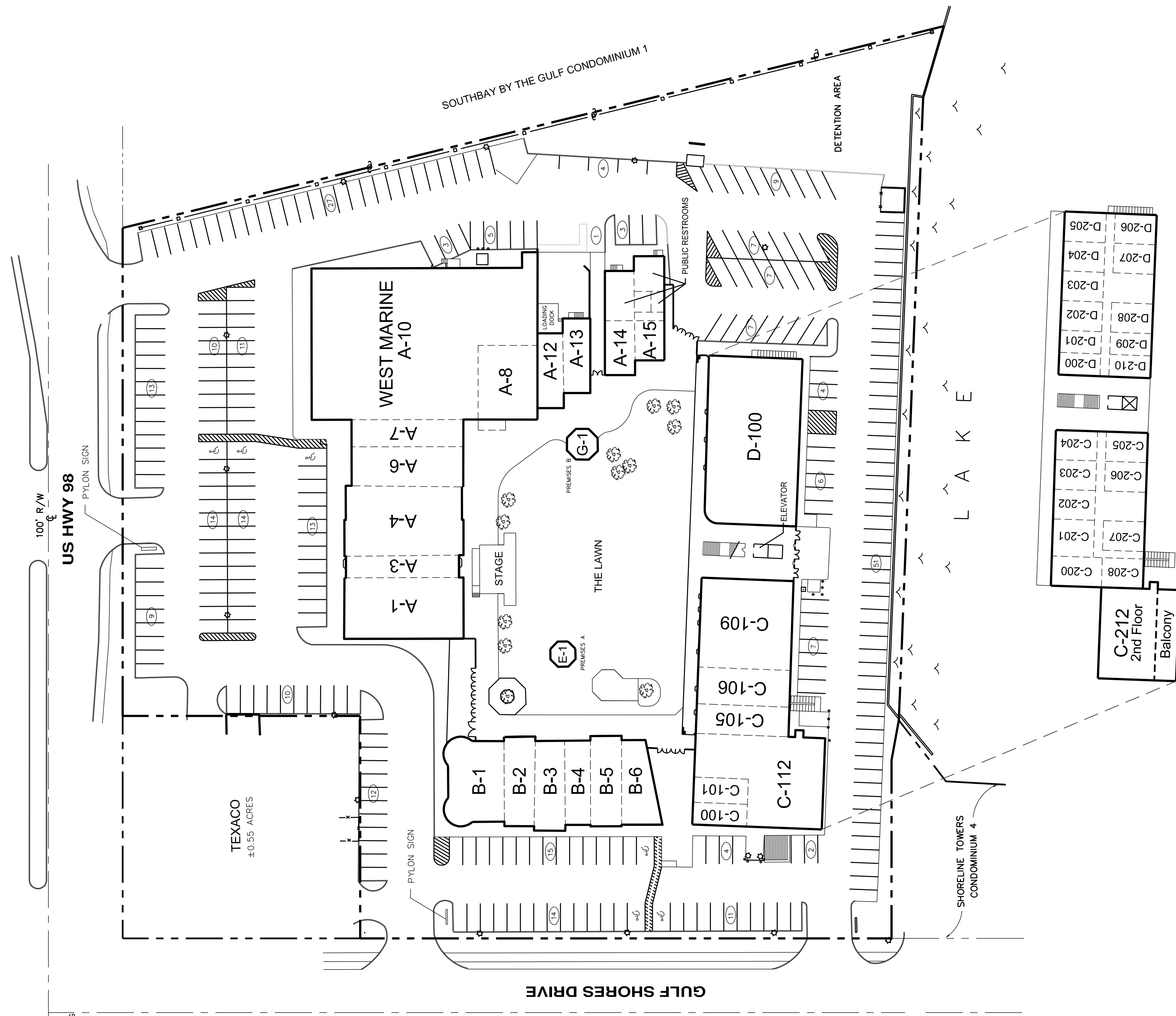

## UPPER LEVEL RENTALS

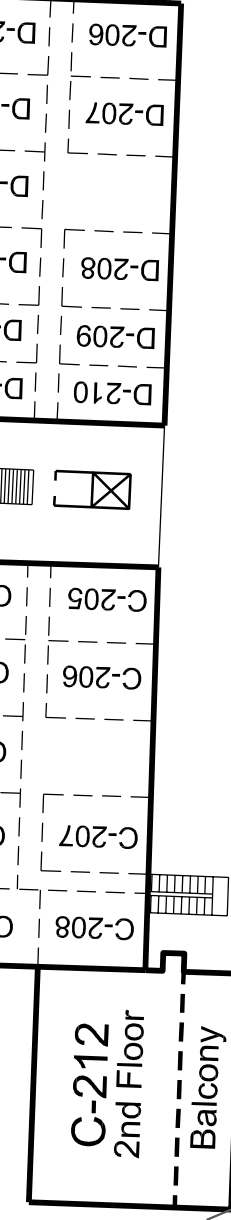

LEASE DIMENSIONS ARE TO THE OUTSIDE OF EXTERIOR WALLS & STOREFRONT, TO THE INSIDE OF WALLS ABUTTING MAJOR TENANTS, TO THE CENTER LINE OF DEMISING PARTITIONS AND TO THE NONLEASEABLE SIDE OF PARTITIONS AT SPRINKLER ROOMS. AREAS ARE ROUNDED OFF TO THE NEAREST ONE-HALF SQUARE FOOT.

THIS EXHIBIT IS DIAGNOSTIC AND IS INTENDED ONLY FOR THE PURPOSE OF INDICATING THE LOCATION OF THE PREMISES IN THE SHOPPING CENTER. EXCEPT AS MAY BE OTHERWISE EXPRESSLY SET FORTH IN THE LEASE, THE LANDLORD RESERVES THE RIGHT TO MAKE CHANGES IN THE SITE PLAN AS THE LANDLORD DEEMS NECESSARY OR APPROPRIATE.