

NEWMANS CROSSING

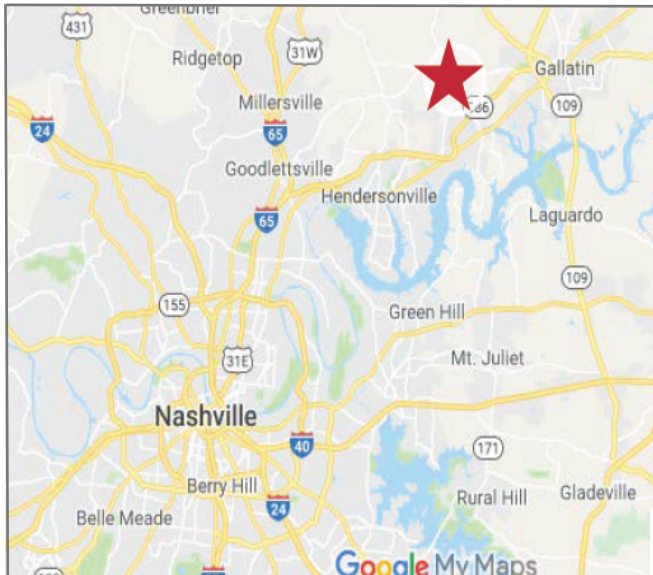

FOR LEASE • NEWMANS CROSSING PUBLIX ANCHORED CENTER



- Shop Space - ~~14,400 SF~~ only 1,030 SF
- +/- 1.17 Acre Outparcel A **LEASED**
- New Sumner County Three-School Campus 0.9 mile from site.
- One of the top 10 fastest growing cities in Tennessee
- 2,192 homes under construction or approved in 2019 in trade area.

FOR LEASE • NEW DEVELOPMENT

John Abernathy - 205-972-9627 - johna@blackwaterresources.com

NEWMANS CROSSING

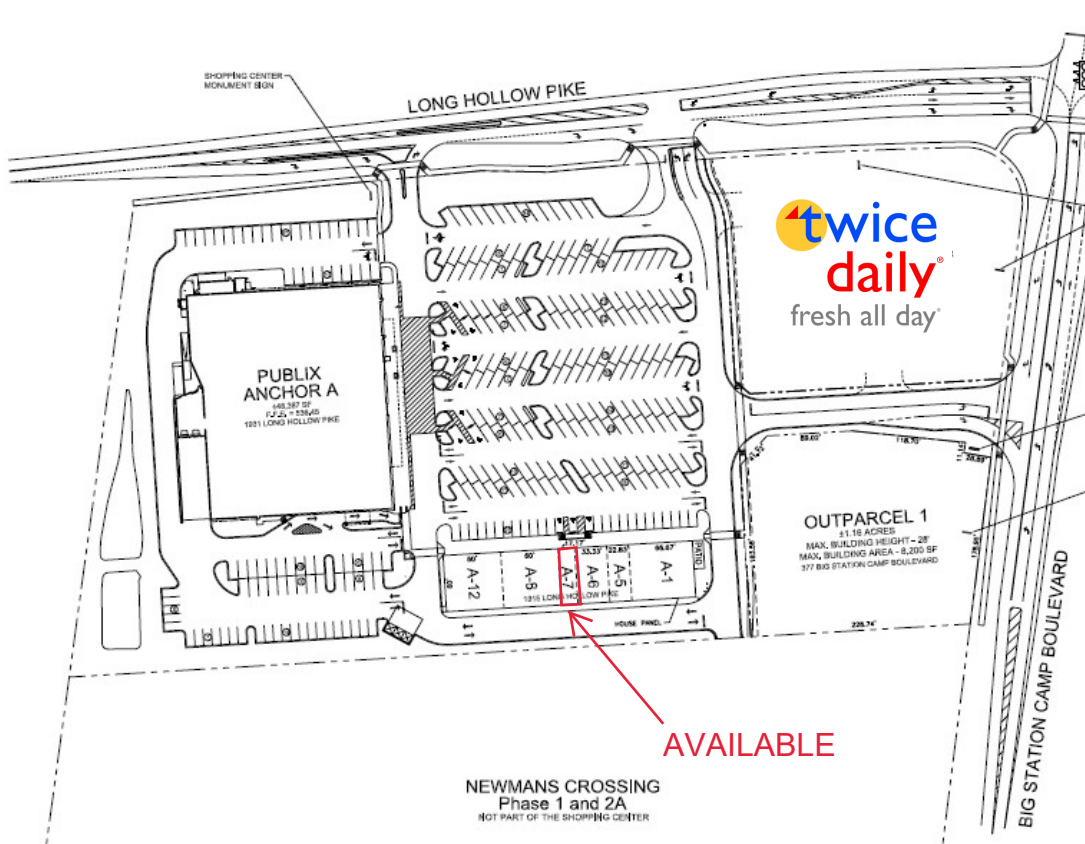

DEMOGRAPHICS

Trade Area
Babg'Sf[a]
21,834
Avg. HH Income
\$108,936



FOR LEASE • NEW DEVELOPMENT

John Abernathy - 205-972-9627 - johna@blackwaterresources.com